

8 7 6 5 4 3 2 1

REV.	DESCRIPTION	BY	DATE
0	INITIAL CONTROL	cmansfield	9/21/2009

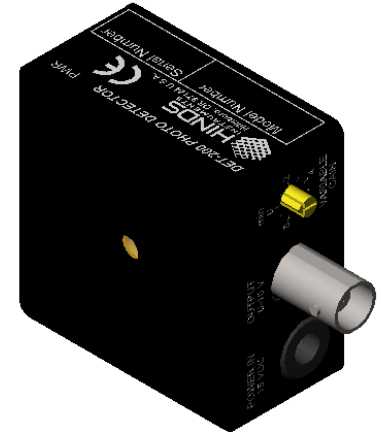

8-32 Tapped Hole for Post Mounting

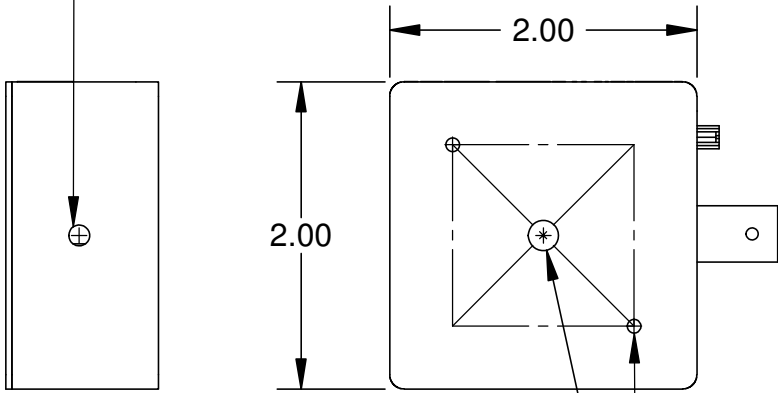

∅.20  
Light Entrance Aperture

4-40 Tapped Holes on a 30x30mm Grid for Cage Mounting

Adjustable Gain Dial

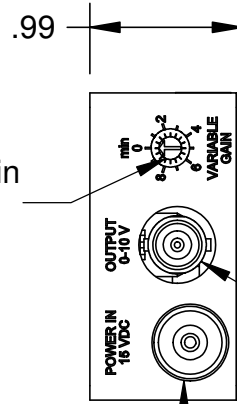

15 V Power

Signal Out

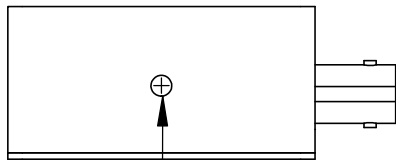

8-32 Tapped Hole for Post Mounting

UNSPECIFIED LIMITS DIMENSIONS IN INCHES		DO NOT SCALE DRAWING		HINDS <sup>®</sup> INSTRUMENTS		Hinds Instruments, Inc. 7245 NW Evergreen Pkwy Hillsboro, OR 97124 PHONE (503) 690-2000 FAX (503) 690-3000		
FRACTIONS	± 1/32	STRAIGHTNESS &/OR FLATNESS: .005/INCH	DATE PRINTED	<b>DET-200, OD</b>				
DECIMALS	.XX ± .010 .XXX ± .005	THREADS: EXTERNAL - CLASS 2A INTERNAL - CLASS 2B	APPROVALS					DATE
HOLE DIA's	.XX ± .005 .XXX ± .001	UNMARKED ANGLES, BENDS & INTERSECTIONS: 90°	DRAWN					
ANGLES	± 0° 30'	MACHINED SURFACES: 63 OR BETTER	CHECKED					
BENDS	± 2°	REMOVE ALL BURRS & SHARP CORNERS	MATERIAL					
PERPENDICULARITY	.003/INCH	SAMPLES MUST BE APPROVED BY ENGINEERING DEPARTMENT PRIOR TO STARTING PRODUCTION	FINISH	SCALE	FSCM NO.	DRAWING NO.	REV.	
CONCENTRICITY	.003 TIR	THIS DRAWING IS THE PROPERTY OF HINDS INSTRUMENTS INC. ALL RIGHTS RESERVED.		4:5		<b>09212009-01</b>	<b>0</b>	
					RELEASE DATE:	SHEET	OF	
						<b>1</b>	<b>1</b>	

8 7 6 5 4 3 2 1